

AIA 2012 NATIONAL CONVENTION AND DESIGN EXPOSITION

MAY 17-19

WALTER E. WASHINGTON
CONVENTION CENTER
WASHINGTON, D.C.



THE AMERICAN
INSTITUTE
OF ARCHITECTS

DESIGN CONNECTS

FR208

DEAFSPACE: AN ALTERNATIVE PERSPECTIVE ON ARCHITECTURE, THE SENSES, AND CULTURAL EXPRESSION

5/18/2012, 2:00:00 PM—3:30:00 PM

1.50 LU | HSW

Program Description

Deaf people inhabit a rich sensory world where vision and touch are a primary means of spatial awareness and orientation. Many use visually centered sign language as a primary mode of communication and maintain a strong cultural identity rooted in these cognitive and linguistic sensibilities. This presentation proposes that deaf people possess an intrinsic spatial aesthetic that, while it remains largely dormant, offers valuable insights about the interrelationship between the senses, how we construct the built environment, and cultural identity. The concept of a deaf aesthetic known as DeafSpace offers a new voice in the discourse on design and disabilities as well as on integrated project delivery methodologies. The session chronicles the development of an integrated project delivery methodology used by Gallaudet University—the only liberal arts university in the world dedicated to the education of deaf and hard-of-hearing people—to ensure that new campus buildings are responsive to and express the unique deaf ways of being while creating new academic research program platforms that explore the nexus of architecture, the senses, and project delivery methodologies. Architect Hansel Bauman, AIA, of the DeafSpace Project will provide an overview to the DeafSpace concept, the Gallaudet campus, the DeafSpace Campus Design Guide, and the new “Living and Learning Residence Hall No. 6” (LLRH6) now under construction. Robert Sirvage, a Gallaudet alumnus and DeafSpace design specialist, will provide examples of his research on deaf interactions in the campus environment that was much of the basis for the DeafSpace Design Guide. David Lewis of LTL Architects and Jeff Luker, AIA, of Quinn Evans Architects will discuss lessons learned from the design-build competition that selected their firms for the LLRH6 project. When LLRH6 opens its doors in fall 2012, it will be a milestone in the evolution of DeafSpace and serve as solid evidence of the unique contribution that deaf people can make to architectural discourse through an embodied, aesthetic approach that goes beyond the idea of adaptability often promoted by the ADA or even universal design.

Learning Objectives:

- DISCOVER HOW EMPATHETIC DESIGN METHODOLOGIES IMPROVE PRACTICAL AND AESTHETIC RESULTS
- EXPLORE THE UNIQUE CHALLENGES AND OPPORTUNITIES ASSOCIATED WITH DEAFSPACE ARCHITECTURE—AND HOW THESE LESSONS CAN BE APPLIED TO ACCESSIBILITY DESIGN AND BEST PRACTICES FOR PUBLIC SPACES
- OBSERVE A RECENT APPLICATION OF THE EVOLVING DEAFSPACE GUIDELINES
- RECOGNIZE THE UNIQUE SENSIBILITIES THAT DEAF PEOPLE BRING TO ARCHITECTURAL DISCOURSE

PROVIDER: GALLAUDET UNIVERSITY

SPEAKERS: HANSEL SEWELL BAUMAN; DAVID J. LEWIS, AIA; JEFFREY C. LUKER, AIA, LEED AP; AND ROBERT SIRVAGE

This presentation is protected by U.S. and international copyright laws. Reproduction, distribution, display, and use of the presentation without written permission of the speaker is prohibited.

This program is registered with the AIA/CES for continuing professional education. As such, it does not include content that may be deemed or construed to constitute approval, sponsorship, or endorsement by the AIA of any method, product, service, enterprise, or organization. The statements expressed by speakers, panelists, and other participants reflect their own views and do not necessarily reflect the views or positions of the American Institute of Architects or of AIA components, or those of their respective officers, directors, members, employees, or other organizations, groups, or individuals associated with them. Questions related to specific products and services may be addressed at the conclusion of this presentation.

Hansel S. Bauman

Director of Campus Planning and Design

Gallaudet University , hbhm Architecture , Washington , DC

Hansel Bauman is founding partner of hbhm architecture and is an adjunct faculty member and director of campus design + planning at Gallaudet University. Mr. Bauman has over twenty years of experience in architecture, planning and Urban Design. His portfolio includes buildings for universities and scientific research centers in the United States, Europe and Asia. His professional and academic work explores the intersection of culture, the senses and architecture. Mr. Bauman is an emerging expert in the field of “Deaf Architecture”. In collaboration with Deaf Studies Department at Gallaudet University he established the DeafSpace Project in 2005—a three year-long research and campus design project leading to the cutting edge “DeafSpace Design Guide”. His most recent works include the DeafHope social services and transitional housing community in Oakland California, concept design for the Innovation Lab at Gallaudet University and design guidelines for the Ireland National Deaf Center, Dublin Ireland.



Role: Speaker

David J. Lewis, AIA

Principal

Lewis.Tsurumaki.Lewis (LTL Architects), New York , NY

David J. Lewis is a founding principal of Lewis.Tsurumaki.Lewis (LTL Architects), a design intensive architecture firm located in New York City. David J. Lewis holds a Master of Architecture from Princeton University, a Master of Arts in the History of Architecture and Urbanism from Cornell University, and a Bachelor of Arts from Carleton College. David is an Associate Professor at Parsons The New School for Design, where he has led the Solar Decathlon studio, directed the Design Workshop program and Master of Architecture program. He has also taught at Cornell University, the University of Pennsylvania, University of Limerick, and Ohio State University. He serves as a founding member of the Advisory Board of the School of Architecture at the University of Limerick, Ireland. LTL Architects is the recipient of the 2007 National Design Award for Interior Design from the Cooper-Hewitt, National Design Museum and was selected as one of six American architectural firms featured in the U.S. Pavilion at the 2004 Venice Architecture Biennale. LTL Architects was included in the inaugural National Design Triennial at the Cooper-Hewitt in 2000. Their work is in the permanent collections of the San Francisco Museum of Modern Art and the Heinz Architectural Center at the Carnegie Museum of Art. The principals are co-authors of two books, the monograph *Opportunistic Architecture* (Princeton Architectural Press, 2008) and *Situation Normal....Pamphlet Architecture #21* (Princeton Architectural Press, 1998).

Role: Speaker

Jeffrey C. Luker, AIA, LEED AP

Quinn Evans Architects, Washington, DC

Jeff Luker recommends that architectural success begins with a heartfelt appreciation for context and flourishes when friends commit to excellent design and collaborate effectively -"Together, we create projects that celebrate the past and improve our future". As Principal with Quinn Evans Architects, J. Luker strives to celebrate history and transform place; to create an architecture that is fresh and Sustainable. Inspired by the robust character of Italy's Tuscan hilltop villages, the trans-formative skyscrapers created by Louis Sullivan and the more recent "archi-neering" espoused by Helmut Jahn; Mr. Luker looks for opportunities to optimize the use of existing buildings as we develop new projects that improve both the utility and inspiration of our built environment. During his long career with Quinn Evans, Mr. Luker has enjoyed opportunities to work on many of the Country's most significant buildings including renewal work in the White House, and restoration work at the Old Executive Office and the US Treasury Buildings in Washington, DC. The quality demanded in these settings has informed his work on company policies regarding project management, contract documentation and construction administration. More recently, Mr. Luker is especially proud of his leadership role on collaborations with the DC Government on the renewed HD Cooke Elementary School; the Smithsonian Institution on the new Seal and Sea Lion Exhibit at the National Zoological Park and Gallaudet University on a New Living and Learning Center located on the Campus Green, Washington, DC.

Role: Speaker

Robert Sirvage

Gallaudet University , Washington , DC

Mr. Sirvage Graduated from Gallaudet University with a Masters Degree in Deaf Studies in 2010. He has worked as a research assistant and designer in the Gallaudet Office of Design + Planning since 2009 where he played a key role in developing research methodologies and DeafSpace design concepts. His graduate theses explores proxemics, visual language and architecture. He research is published in the Deaf Studies Digital Journal at dsdj.gallaudet.edu 'RAW' Mr. Sirvage has also served as an adjunct faculty member in the Gallaudet Deaf Studies Department where he continues his research in DeafSpace.

AIA 2012
 NATIONAL CONVENTION
 AND DESIGN EXPOSITION
 MAY 17-19
 WALTER E. WASHINGTON
 CONVENTION CENTER
 WASHINGTON, D.C.

DESIGN
 CONNECTS

DeafSpace:
 An Alternative perspective on
 architecture the senses and cultural
 expression

SESSION ID: FR 208
 [Friday, May 18 2012, - 2:00PM – 3:30 PM]

THE AMERICAN
 INSTITUTE
 OF ARCHITECTS

AIA 2012
 NATIONAL CONVENTION
 AND DESIGN EXPOSITION
 MAY 17-19
 WALTER E. WASHINGTON
 CONVENTION CENTER
 WASHINGTON, D.C.

DESIGN
 CONNECTS

This presentation is protected by US and International
 Copyright laws. Reproduction, distribution, display and use of
 the presentation without written permission of the speaker is
 prohibited.

AIA 2012
 NATIONAL CONVENTION
 AND DESIGN EXPOSITION
 MAY 17-19
 WALTER E. WASHINGTON
 CONVENTION CENTER
 WASHINGTON, D.C.

DESIGN
 CONNECTS

Acknowledgements/Credits

- DeafSpace Participants: DeafSpace visionaries and authors
- ASL, Deaf Studies Department, Gallaudet University
- Gallaudet University Administration
- SmithGroup Architects, Sorenson Language and Communication Center
- Bruce Dunlop Lighting Design
- Hope Mitnick Architect
- Dangermond Keane Architects
- Brailsford & Dunlavey

AIA 2012
NATIONAL CONVENTION
AND DESIGN EXPOSITION
AIA/CES
Continuing Education
Program

DESIGN
CONNECTS

AIA/CES Quality Statement

This program is registered with the AIA/CES for continuing professional education. As such, it does not include content that may be deemed or construed to constitute approval, sponsorship or endorsement by the AIA of any method, product, service, enterprise or organization. The statements expressed by speakers, panelists, and other participants reflect their own views and do not necessarily reflect the views or positions of The American Institute of Architects or of AIA components, or those of their respective officers, directors, members, employees, or other organizations, groups or individuals associated with them. Questions related to specific products, publications, and services may be addressed at the conclusion of this presentation.

AIA 2012
NATIONAL CONVENTION
AND DESIGN EXPOSITION
AIA/CES
Continuing Education
Program

DESIGN
CONNECTS

Learning Objectives

1. Understanding how empathetic design methodologies improve practical and aesthetic results
1. Understand the unique challenges and opportunities associated with DeafSpace architecture how these lessons can be applied to accessibility design and best practices for public spaces.
1. Witness a recent application of the evolving DeafSpace Guidelines.
1. Understand the unique sensibilities that deaf people bring to architectural discourse

Agenda

Deaf Ways-of-Being
Robert Sirvage, DeafSpace Project

DeafSpace Project: A Way of Building
Hansel Bauman, AIA DeafSpace Project

LLRH6 Case Study: DeafSpace in the Making
David Lewis, AIA, LTL Architects
Jeff Luker, AIA, Quinn Evans Architects

Future Directions in Deaf Epistemologies
Robert Sirvage, DeafSpace Project

DeafSpace
+
DEAF WAYS OF BEING

Robert Sirvage

DeafSpace
+
LLRH6 Preview Video

Robert Sirvage



"The occupation of space is the first proof of existence."
Le Corbusier



Disability, Isolation, and Paternalism

DeafSpace Project
On Codifying Deaf Architecture
A pattern language
+
A way of building, A way of dwelling
Hansel Bauman, AIA

DeafSpace: Gallaudet University Living and Learning Residence Hall

AIA Convention 2012

If no one was around, how could you tell Gallaudet is deaf place?



Gallaudet University



Harvard University

DEAF SPACE WORKSHOP



A PLACE OF CONNECTION

organic in nature: open, light, quiet, flowing, smooth and rich with cultural metaphors that reflect the inherent diversity of the deaf community.

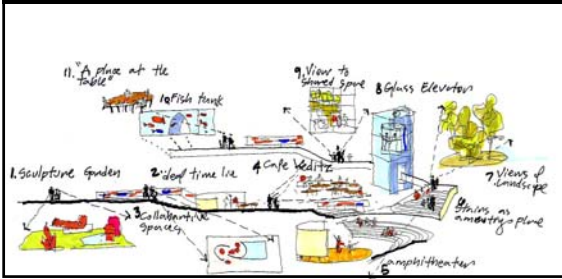

Sorenson Language and Communication Center



DeafSpace Project The making of a pattern language

Organic process pushes a paradigm shift



"From Hearing **Loss** to Deaf **Gain**"

"In search of a place of our own"
Gallaudet campus as research laboratory



DeafSpace Design Guidelines: Codifying ways of connection

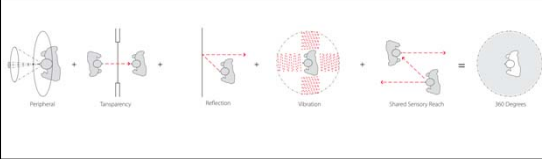

1 Sensory Reach + Connectivity

- 1.1.2 View Corridors
- 1.2 Transparency + Privacy
1.3 Reflection
- 1.5.2 Vibration Zones

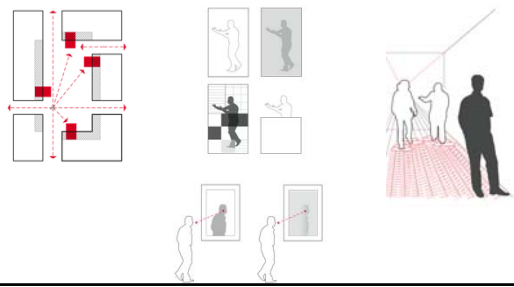

1| Space + Proximity

- 2.1.1 Circulation Space
- 2.2.1 Seating Arrangements

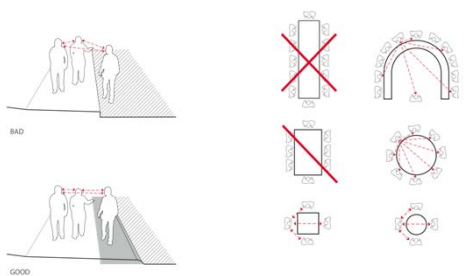

III Design for Mobility

3.1.2 Pathway Flow

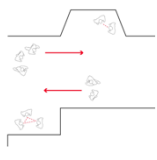

3.1.6 Soft Intersections

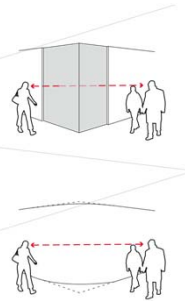

3.3.1 Rhythm + Datum

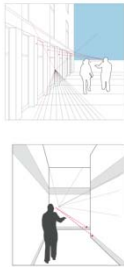

1V Color + Light

4.1.4 Color: Contrasting Surface + Visual Language



4.2 Multiple Light Sources

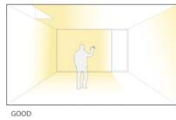

Acoustics + EMI

5.1.1 Sound Reverberation: Shaping Space

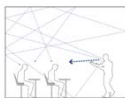
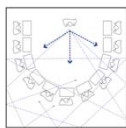

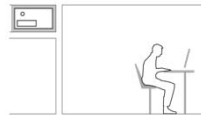
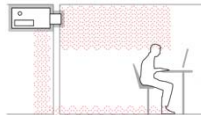

5.2.1 EMI: Shielding Isolating Sources



DeafSpace Project
On Ways of Building, Ways of Dwelling
+

A way of dwelling

Orientation + Identification vs. Accommodation





A way of building

Vernacular

Vs.



Common Practice

Particularity over universality

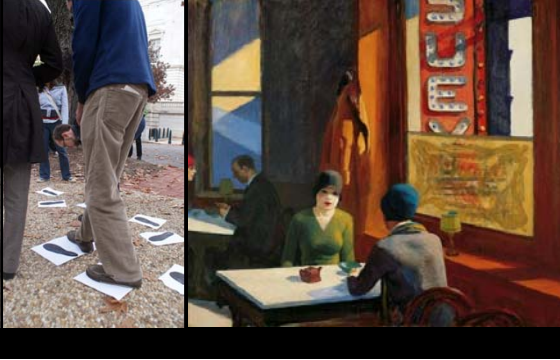

DeafSpace Project
+
Evolution of the Deaf way of building

Gallaudet University Campus



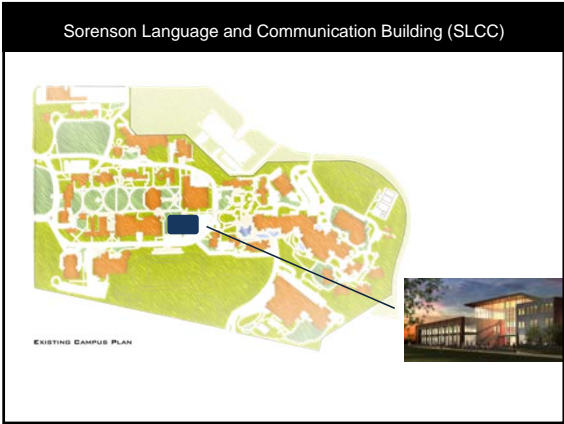

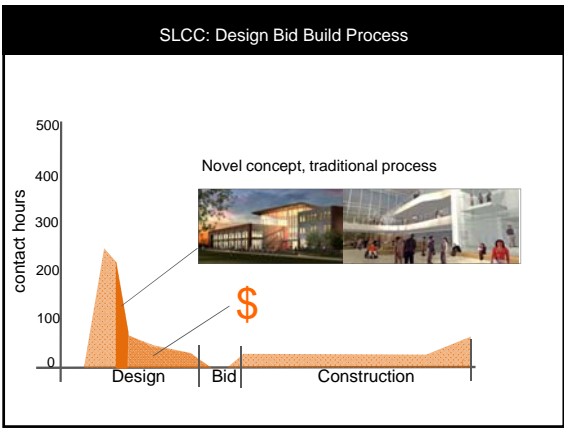





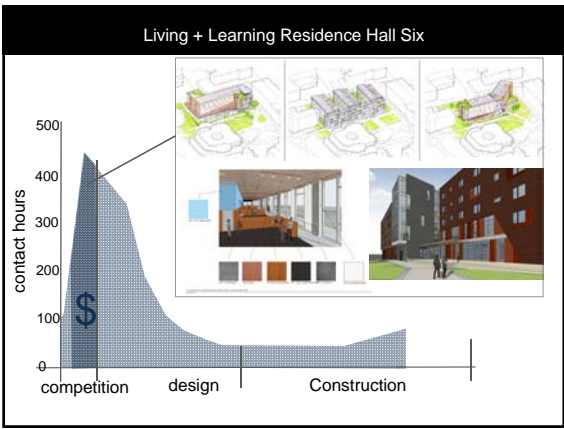

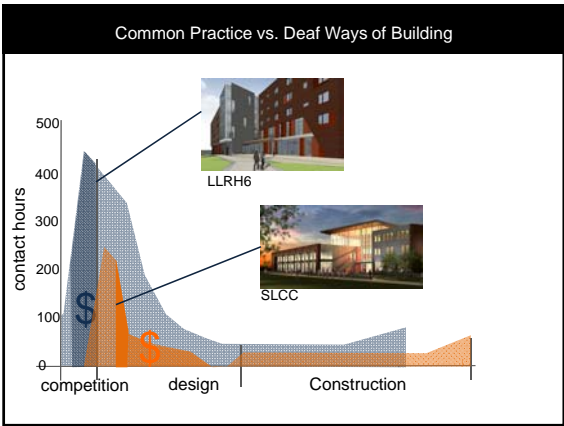



DESIGN PROCESS: COMPETITION

CAMPUS-WIDE INPUT
ON DEAF-SPACE GOALS

DeafSpace: Gallaudet University Living and Learning Residence Hall AIA Convention 2012

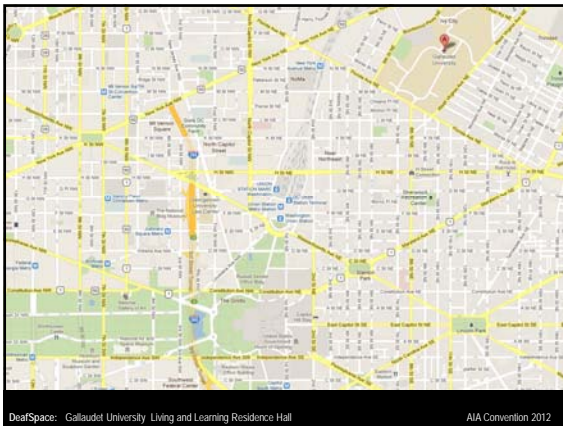

DeafSpace: Gallaudet University Living and Learning Residence Hall AIA Convention 2012



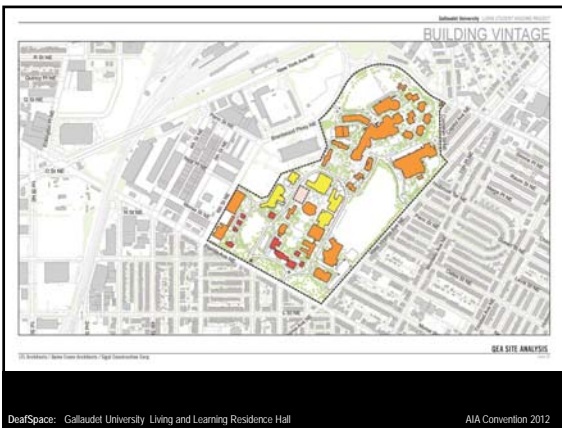

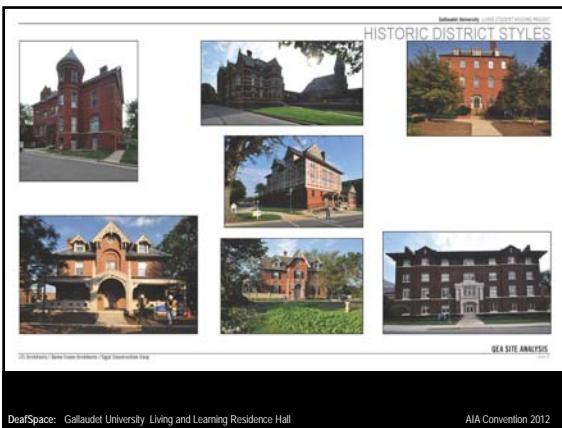



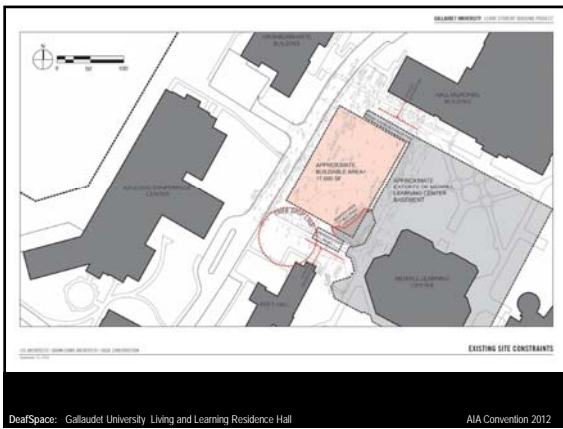

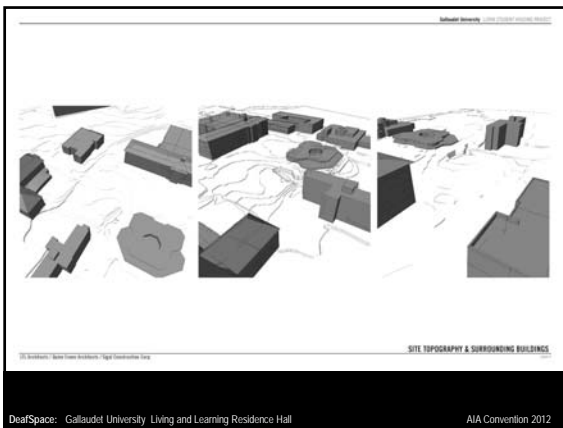

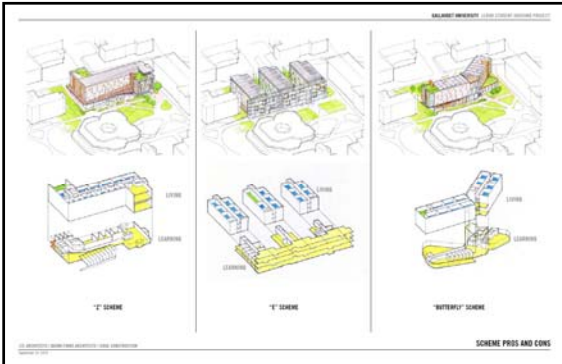

DeafSpace: Gallaudet University Living and Learning Residence Hall AIA Convention 2012



DeafSpace: Gallaudet University Living and Learning Residence Hall AIA Convention 2012



DeafSpace: Gallaudet University Living and Learning Residence Hall AIA Convention 2012



DeafSpace: Gallaudet University Living and Learning Residence Hall

AIA Convention 2012



DeafSpace: Gallaudet University Living and Learning Residence Hall

AIA Convention 2012



DeafSpace: Gallaudet University Living and Learning Residence Hall

AIA Convention 2012



DeafSpace: Gallaudet University Living and Learning Residence Hall AIA Convention 2012



DeafSpace: Gallaudet University Living and Learning Residence Hall AIA Convention 2012



DeafSpace: Gallaudet University Living and Learning Residence Hall AIA Convention 2012

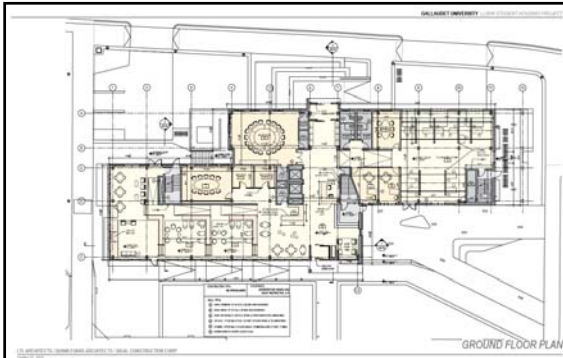

DeafSpace: Gallaudet University Living and Learning Residence Hall AIA Convention 2012



DeafSpace: Gallaudet University Living and Learning Residence Hall AIA Convention 2012



DeafSpace: Gallaudet University Living and Learning Residence Hall AIA Convention 2012

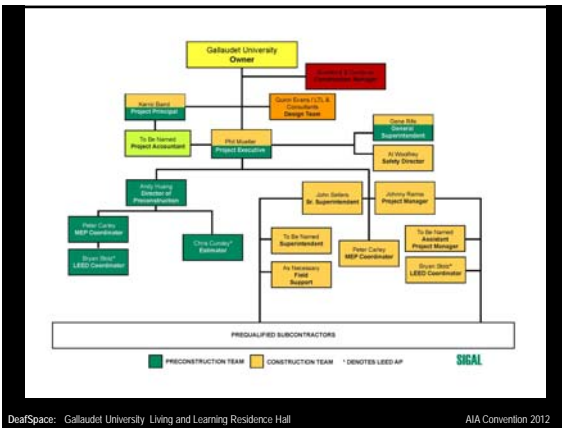

Project Staff		SICAL	
Role	Start	End	Notes
Construction Staff			
1. Project Manager	1/1/10	1/1/11	
2. Project Assistant	1/1/10	1/1/11	
3. Project Superintendent	1/1/10	1/1/11	
4. Structural Engineer	1/1/10	1/1/11	
5. Electrical	1/1/10	1/1/11	
6. MEP Coordinator	1/1/10	1/1/11	
Construction Staff			
1. Project Manager	1/1/10	1/1/11	
2. Project Assistant	1/1/10	1/1/11	
3. Project Superintendent	1/1/10	1/1/11	
4. MEP	1/1/10	1/1/11	
5. Electrical	1/1/10	1/1/11	
6. MEP Coordinator	1/1/10	1/1/11	
7. Project Superintendent	1/1/10	1/1/11	
8. Electrical	1/1/10	1/1/11	
9. MEP	1/1/10	1/1/11	
10. Project Superintendent	1/1/10	1/1/11	
11. MEP	1/1/10	1/1/11	
12. Project Superintendent	1/1/10	1/1/11	
13. MEP	1/1/10	1/1/11	
14. Project Superintendent	1/1/10	1/1/11	
15. MEP	1/1/10	1/1/11	
16. Project Superintendent	1/1/10	1/1/11	
17. MEP	1/1/10	1/1/11	
18. Project Superintendent	1/1/10	1/1/11	
19. MEP	1/1/10	1/1/11	
20. Project Superintendent	1/1/10	1/1/11	
21. MEP	1/1/10	1/1/11	
22. Project Superintendent	1/1/10	1/1/11	
23. MEP	1/1/10	1/1/11	
24. Project Superintendent	1/1/10	1/1/11	
25. MEP	1/1/10	1/1/11	
26. Project Superintendent	1/1/10	1/1/11	
27. MEP	1/1/10	1/1/11	
28. Project Superintendent	1/1/10	1/1/11	
29. MEP	1/1/10	1/1/11	
30. Project Superintendent	1/1/10	1/1/11	
31. MEP	1/1/10	1/1/11	
32. Project Superintendent	1/1/10	1/1/11	
33. MEP	1/1/10	1/1/11	
34. Project Superintendent	1/1/10	1/1/11	
35. MEP	1/1/10	1/1/11	
36. Project Superintendent	1/1/10	1/1/11	
37. MEP	1/1/10	1/1/11	
38. Project Superintendent	1/1/10	1/1/11	
39. MEP	1/1/10	1/1/11	
40. Project Superintendent	1/1/10	1/1/11	
41. MEP	1/1/10	1/1/11	
42. Project Superintendent	1/1/10	1/1/11	
43. MEP	1/1/10	1/1/11	
44. Project Superintendent	1/1/10	1/1/11	
45. MEP	1/1/10	1/1/11	
46. Project Superintendent	1/1/10	1/1/11	
47. MEP	1/1/10	1/1/11	
48. Project Superintendent	1/1/10	1/1/11	
49. MEP	1/1/10	1/1/11	
50. Project Superintendent	1/1/10	1/1/11	
51. MEP	1/1/10	1/1/11	
52. Project Superintendent	1/1/10	1/1/11	
53. MEP	1/1/10	1/1/11	
54. Project Superintendent	1/1/10	1/1/11	
55. MEP	1/1/10	1/1/11	
56. Project Superintendent	1/1/10	1/1/11	
57. MEP	1/1/10	1/1/11	
58. Project Superintendent	1/1/10	1/1/11	
59. MEP	1/1/10	1/1/11	
60. Project Superintendent	1/1/10	1/1/11	
61. MEP	1/1/10	1/1/11	
62. Project Superintendent	1/1/10	1/1/11	
63. MEP	1/1/10	1/1/11	
64. Project Superintendent	1/1/10	1/1/11	
65. MEP	1/1/10	1/1/11	
66. Project Superintendent	1/1/10	1/1/11	
67. MEP	1/1/10	1/1/11	
68. Project Superintendent	1/1/10	1/1/11	
69. MEP	1/1/10	1/1/11	
70. Project Superintendent	1/1/10	1/1/11	
71. MEP	1/1/10	1/1/11	
72. Project Superintendent	1/1/10	1/1/11	
73. MEP	1/1/10	1/1/11	
74. Project Superintendent	1/1/10	1/1/11	
75. MEP	1/1/10	1/1/11	
76. Project Superintendent	1/1/10	1/1/11	
77. MEP	1/1/10	1/1/11	
78. Project Superintendent	1/1/10	1/1/11	
79. MEP	1/1/10	1/1/11	
80. Project Superintendent	1/1/10	1/1/11	
81. MEP	1/1/10	1/1/11	
82. Project Superintendent	1/1/10	1/1/11	
83. MEP	1/1/10	1/1/11	
84. Project Superintendent	1/1/10	1/1/11	
85. MEP	1/1/10	1/1/11	
86. Project Superintendent	1/1/10	1/1/11	
87. MEP	1/1/10	1/1/11	
88. Project Superintendent	1/1/10	1/1/11	
89. MEP	1/1/10	1/1/11	
90. Project Superintendent	1/1/10	1/1/11	
91. MEP	1/1/10	1/1/11	
92. Project Superintendent	1/1/10	1/1/11	
93. MEP	1/1/10	1/1/11	
94. Project Superintendent	1/1/10	1/1/11	
95. MEP	1/1/10	1/1/11	
96. Project Superintendent	1/1/10	1/1/11	
97. MEP	1/1/10	1/1/11	
98. Project Superintendent	1/1/10	1/1/11	
99. MEP	1/1/10	1/1/11	
100. Project Superintendent	1/1/10	1/1/11	

DeafSpace: Gallaudet University Living and Learning Residence Hall AIA Convention 2012











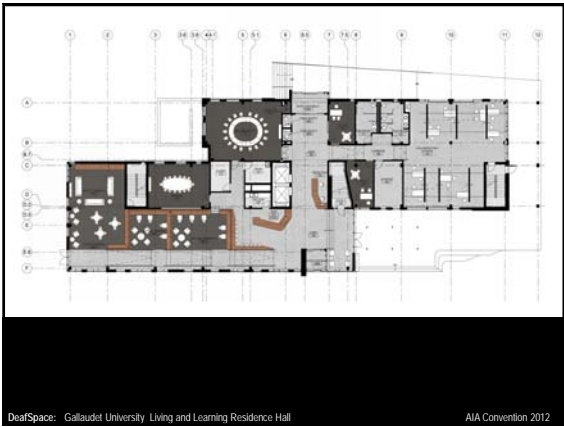

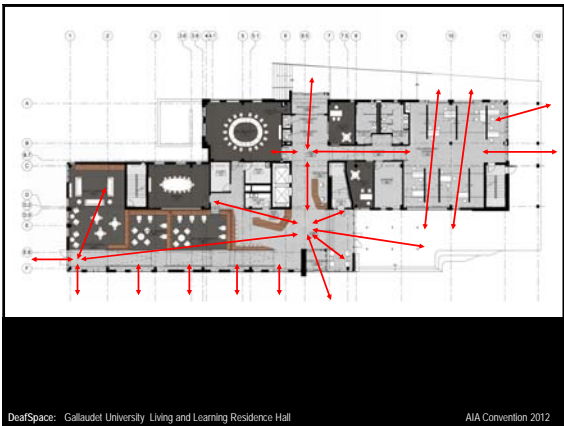







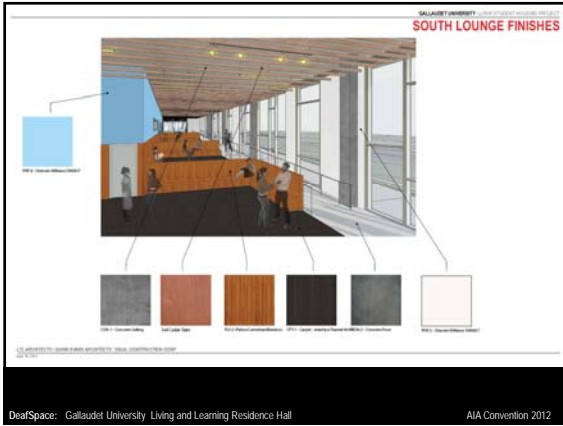



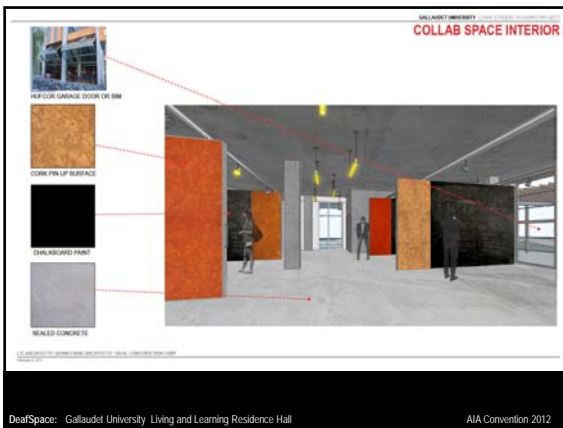



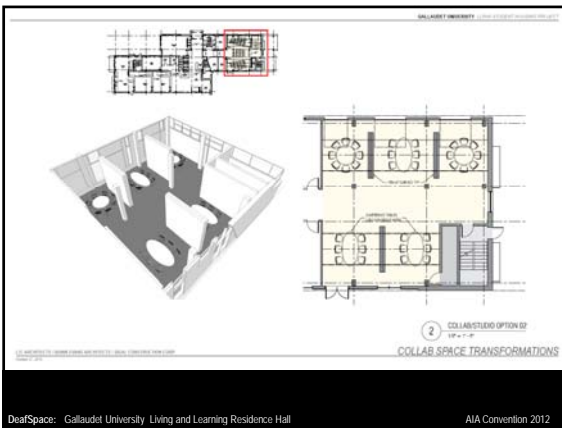

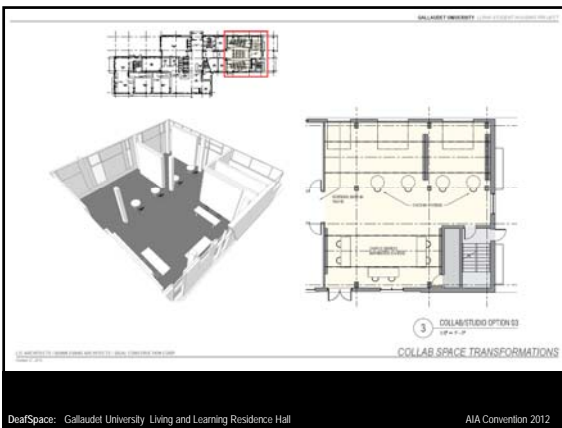



DeafSpace: Gallaudet University Living and Learning Residence Hall

AIA Convention 2012

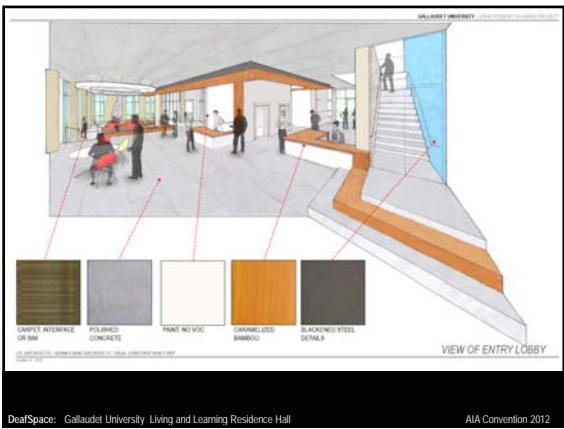

DeafSpace: Gallaudet University Living and Learning Residence Hall

AIA Convention 2012

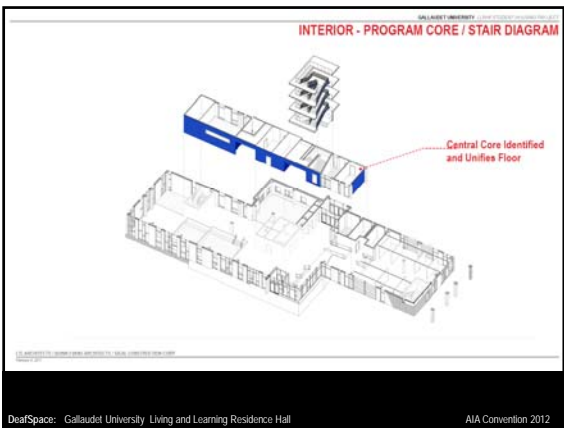

DeafSpace: Gallaudet University Living and Learning Residence Hall

AIA Convention 2012

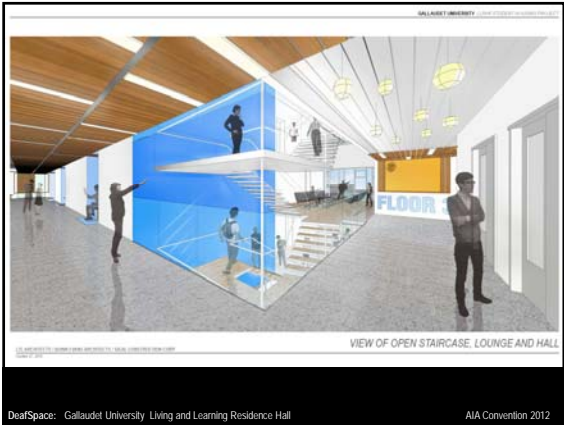









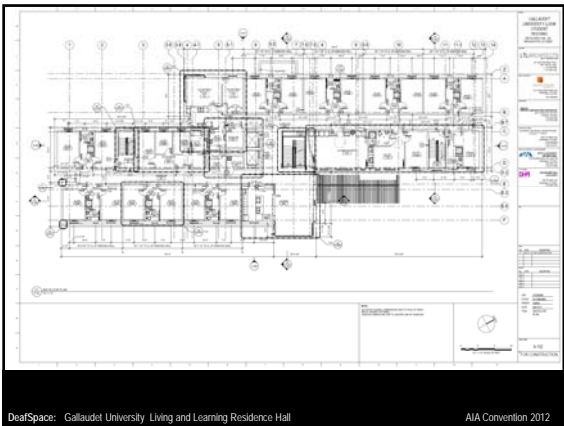





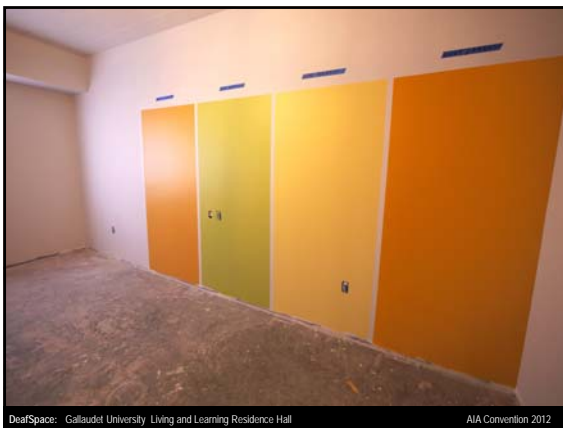

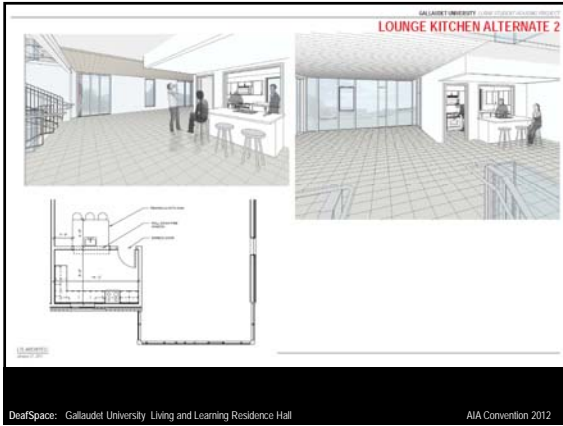

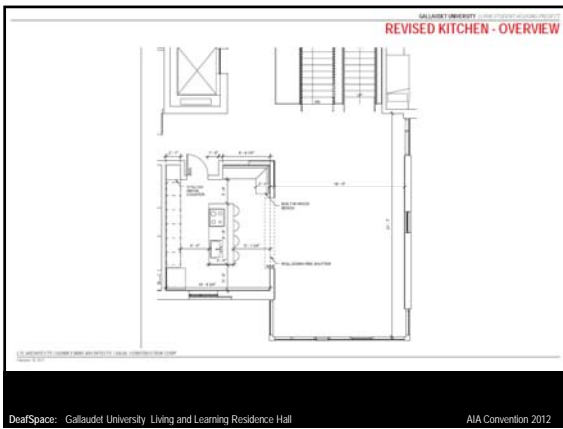

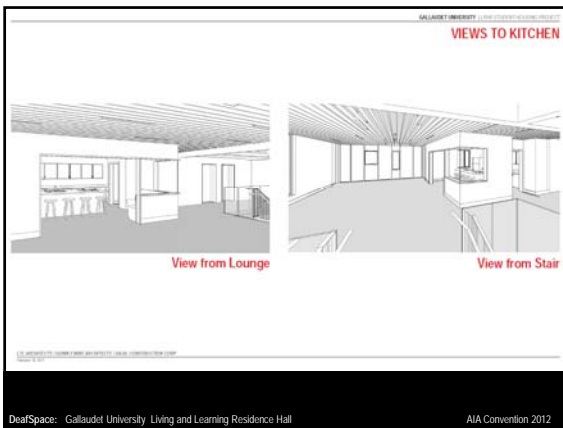





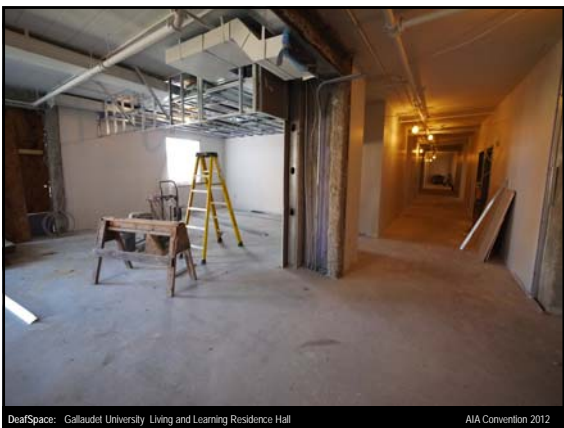



DeafSpace: Gallaudet University Living and Learning Residence Hall AIA Convention 2012

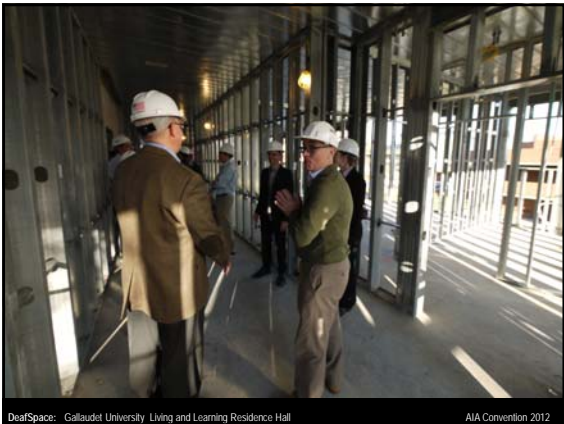

DeafSpace: Gallaudet University Living and Learning Residence Hall AIA Convention 2012



DeafSpace: Gallaudet University Living and Learning Residence Hall AIA Convention 2012



Peripatetic

1. walking or traveling about; itinerant.
2. (initial capital letter) of or pertaining to Aristotle, who taught philosophy while walking in the Lyceum of ancient Athens.
3. (initial capital letter) of or pertaining to the Aristotelian school of philosophy.

noun

4. a person who walks or travels about.
5. (initial capital letter) a member of the Aristotelian school.

Navigational / Proxemics investigation

Deaf Studies Digital Journal third issue (forthcoming)

Developing theory on Deaf Epistemology



Background | Thesis | Deaf Epistemologies

Phonocentrism
"I hear myself speak therefore I exist"

Terminology coined by Jacque Derrida
See Bauman's
Audism – Metaphysics of Oppression.

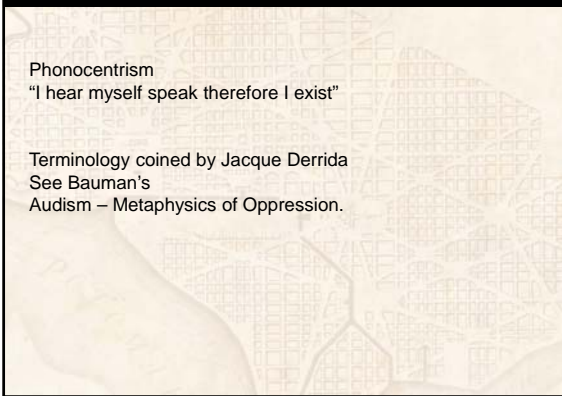

Background | Thesis | Deaf Epistemologies

Starting point Deaf Epistemologies–
"You see me therefore I exist"



Background | Thesis | Deaf Epistemologies

Conventional Selfhood boundary

Dyadic Selfhood boundary

Tivera's Reciprocal Altruism

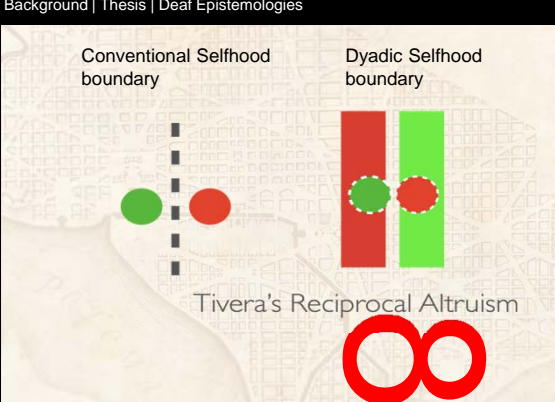

The diagram illustrates two models of selfhood boundaries. On the left, 'Conventional Selfhood boundary' shows two separate circles, one green and one red, with a dashed vertical line between them. On the right, 'Dyadic Selfhood boundary' shows two overlapping circles, one green and one red, with a solid vertical line between them. Below the diagrams is the text 'Tivera's Reciprocal Altruism' and a red infinity symbol.

Background | Deaf Epistemologies

Process of in creation of meaning & its maintenance



The slide features the text 'Process of in creation of meaning & its maintenance' on a background of a faint grid pattern. A red infinity symbol is positioned at the bottom right.

CURRENT RESEARCH | Peripatetic Convergence

Challenge of applying the theory into research

- Experiment with Methodology itself

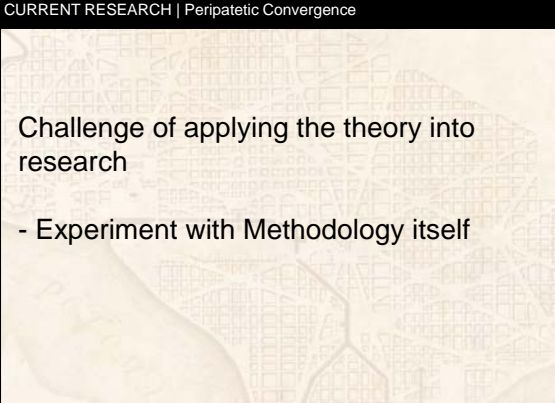

The slide features the text 'Challenge of applying the theory into research' and a bullet point '- Experiment with Methodology itself' on a background of a faint grid pattern. A red infinity symbol is positioned at the bottom right.

Peripatetic (Visual) Convergence



- GoPro camera Headset
- Total 16 individual participant (8 Cases)
- Two different group (Four cases each)
 - KV- Kinesthetic-visual linguistic modality
 - VA- Verbal-audio linguistic modality

Walk through a route (All same) through urban setting in Washington D.C.
 Asked to engage into conversation with each other from beginning to end

Time	Modality
00:00	Visual
00:01	Verbal
00:02	Visual
00:03	Verbal
00:04	Visual
00:05	Verbal
00:06	Visual
00:07	Verbal
00:08	Visual
00:09	Verbal
00:10	Visual
00:11	Verbal
00:12	Visual
00:13	Verbal
00:14	Visual
00:15	Verbal
00:16	Visual
00:17	Verbal
00:18	Visual
00:19	Verbal
00:20	Visual
00:21	Verbal
00:22	Visual
00:23	Verbal
00:24	Visual
00:25	Verbal
00:26	Visual
00:27	Verbal
00:28	Visual
00:29	Verbal
00:30	Visual
00:31	Verbal
00:32	Visual
00:33	Verbal
00:34	Visual
00:35	Verbal
00:36	Visual
00:37	Verbal
00:38	Visual
00:39	Verbal
00:40	Visual
00:41	Verbal
00:42	Visual
00:43	Verbal
00:44	Visual
00:45	Verbal
00:46	Visual
00:47	Verbal
00:48	Visual
00:49	Verbal
00:50	Visual
00:51	Verbal
00:52	Visual
00:53	Verbal
00:54	Visual
00:55	Verbal
00:56	Visual
00:57	Verbal
00:58	Visual
00:59	Verbal
01:00	Visual

Peripatetic Convergence (Cont'd)

1. Coding / Decoding

CASE KV001 DYADVIEW A DYADVIEW B

Time	Modality
00:00	Visual
00:01	Verbal
00:02	Visual
00:03	Verbal
00:04	Visual
00:05	Verbal
00:06	Visual
00:07	Verbal
00:08	Visual
00:09	Verbal
00:10	Visual
00:11	Verbal
00:12	Visual
00:13	Verbal
00:14	Visual
00:15	Verbal
00:16	Visual
00:17	Verbal
00:18	Visual
00:19	Verbal
00:20	Visual
00:21	Verbal
00:22	Visual
00:23	Verbal
00:24	Visual
00:25	Verbal
00:26	Visual
00:27	Verbal
00:28	Visual
00:29	Verbal
00:30	Visual
00:31	Verbal
00:32	Visual
00:33	Verbal
00:34	Visual
00:35	Verbal
00:36	Visual
00:37	Verbal
00:38	Visual
00:39	Verbal
00:40	Visual
00:41	Verbal
00:42	Visual
00:43	Verbal
00:44	Visual
00:45	Verbal
00:46	Visual
00:47	Verbal
00:48	Visual
00:49	Verbal
00:50	Visual
00:51	Verbal
00:52	Visual
00:53	Verbal
00:54	Visual
00:55	Verbal
00:56	Visual
00:57	Verbal
00:58	Visual
00:59	Verbal
01:00	Visual

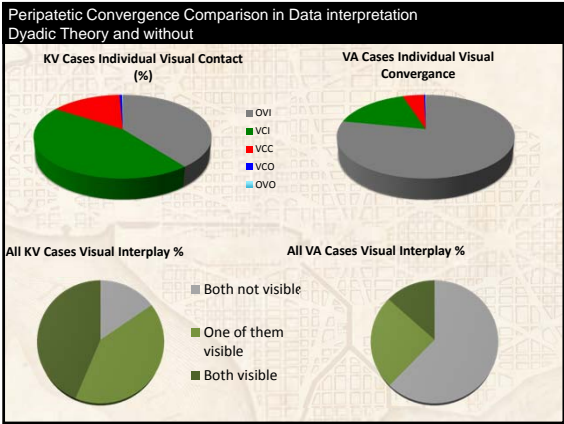

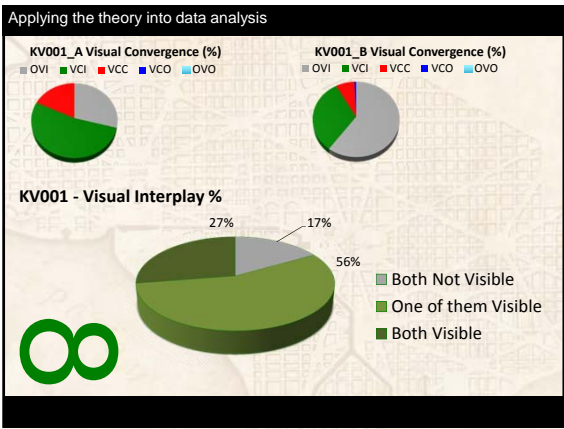

AIA 2012
NATIONAL CONVENTION
AND DESIGN EXPOSITION

DESIGN CONNECTS

Speaker
[List alphabetically by last name regardless of speaking order]

- Hansel Bauman, AIA DeafSpace Project, Gallaudet University
- David Lewis, AIA, LTL Architects
- Jeff Luker, AIA, Quinn Evans Architects
- Robert Sirvage, DeafSpace Project, Gallaudet University
